

This wiring diagram is for a 3 pickup 5-way Nashville style Telecaster but is not stock Nashville. This harness uses a CTS Push-Pull pot for the tone control. and gives you 7 pickup combinations.

- Position #1 Bridge pickup (Rear Position)
- Position #1+PPBridge and Neck (Classic Tele)
- Position #2 Bridge and Middle
- Position #2+PP Bridge, Middle and Neck
- Position #3 Middle pickup
- Position #4 Middle and Neck
- Position #5 Neck pickup (front position)

The Tone Control is a CTS Push-Pull Pot, when you pull it up, it engages the Neck pickup regardless of what position the 5-way switch is in. This gives you the 2 extra positions.

When the 5-way switch is in position #1 you get the normal bridge pickup, but when you pull the push-pull up, you will get bridge and neck. Position #2 normally gives you bridge and middle but when you pull up the push-pull, you will get all 3 pickups together.

These USA made pots have 24 spline shafts, so you will need 24 spline knobs. (Metric and imported pots use 18 spline knobs).

Scroll down to the next page for the diagram

These wiring diagrams assume you are using a metal control plate. If you are not using a metal control plate, you will need to run a small ground wire from the volume pot to the tone pot.

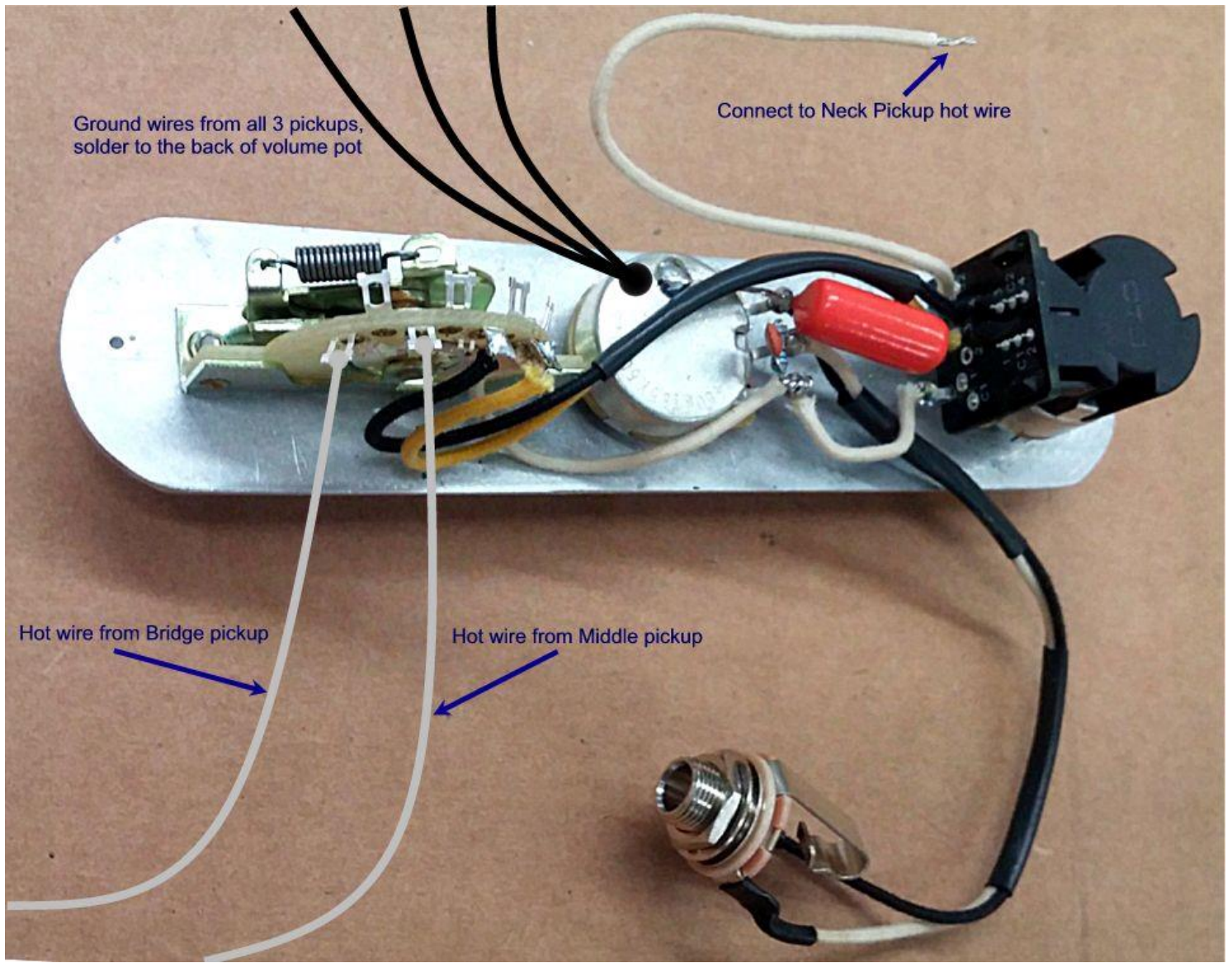

If you need any help hooking it up, please contact me through the [CONTACT US](#) page of this website

Scroll down to the next page for the Line Drawing

3 Pickup, 7 Sound Tele

Master Volume with Treble Retention Circuit,
Master Tone, 5 Way Selector Switch

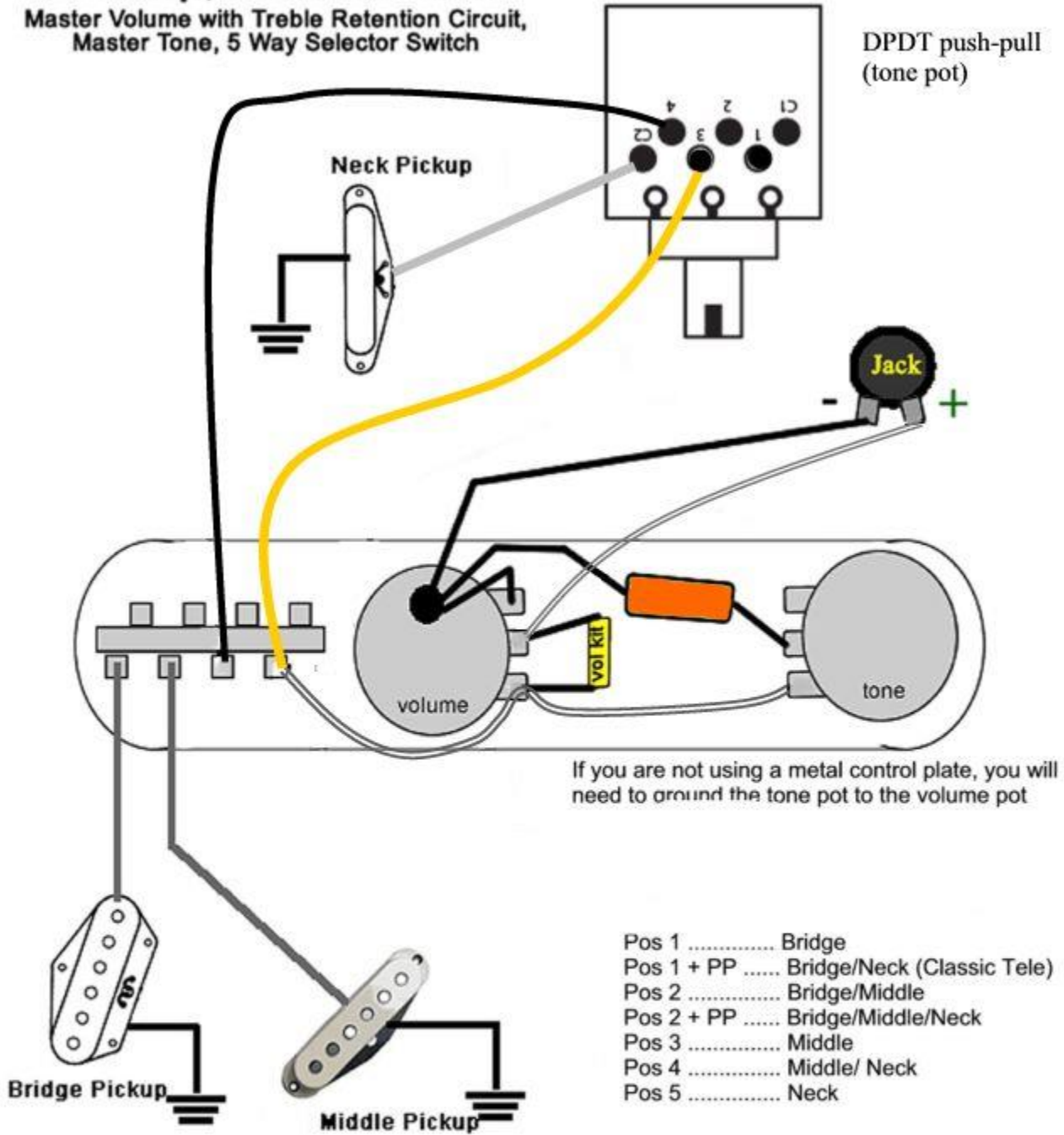

All pickup grounds solder to the back of the volume pot

Scroll down for the Reverse harness wiring diagram

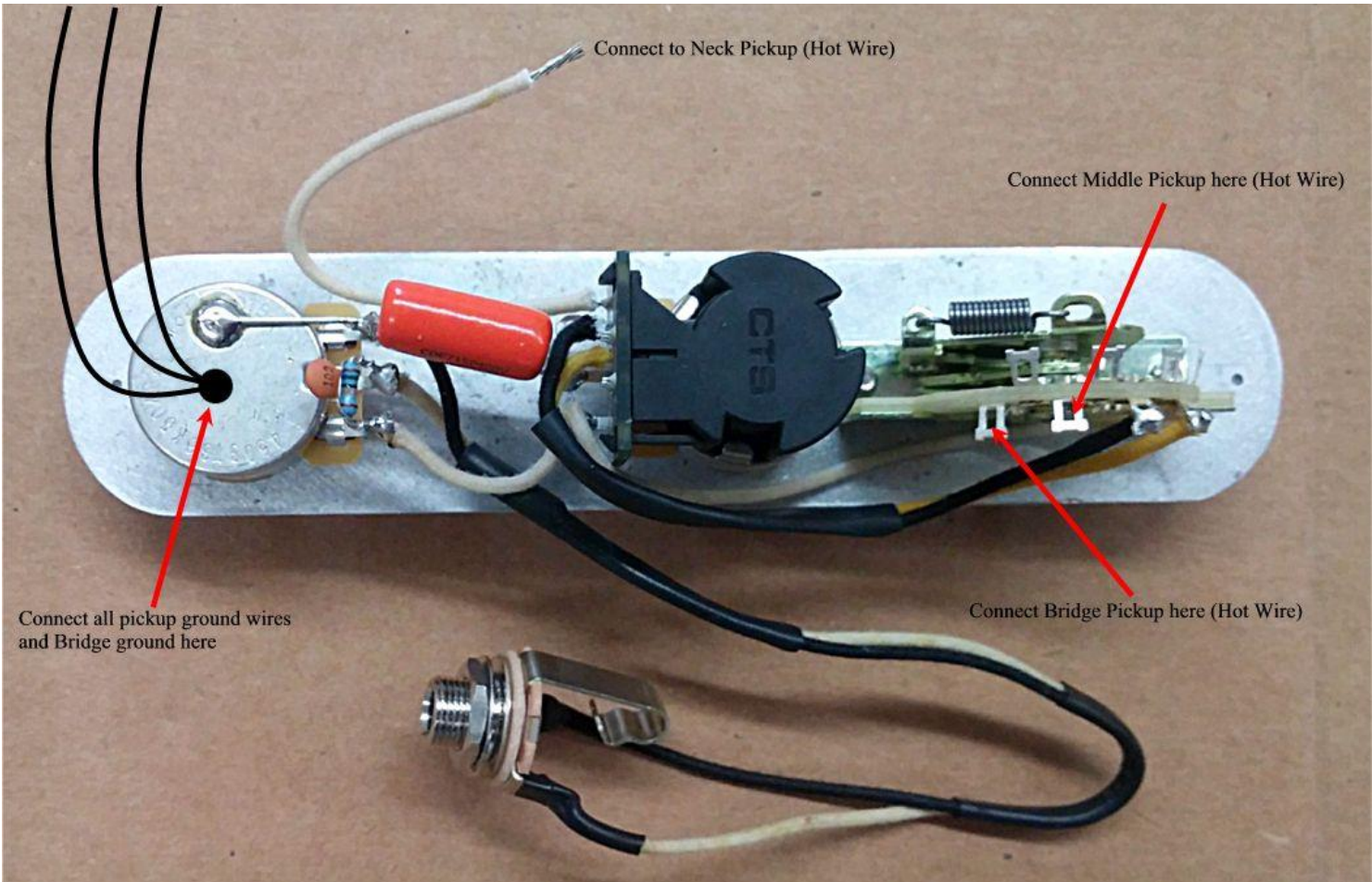

Connect to Neck Pickup (Hot Wire)

Connect Middle Pickup here (Hot Wire)

Connect all pickup ground wires
and Bridge ground here

Connect Bridge Pickup here (Hot Wire)