

Bill Lawrence 5-way Wiring Diagrams

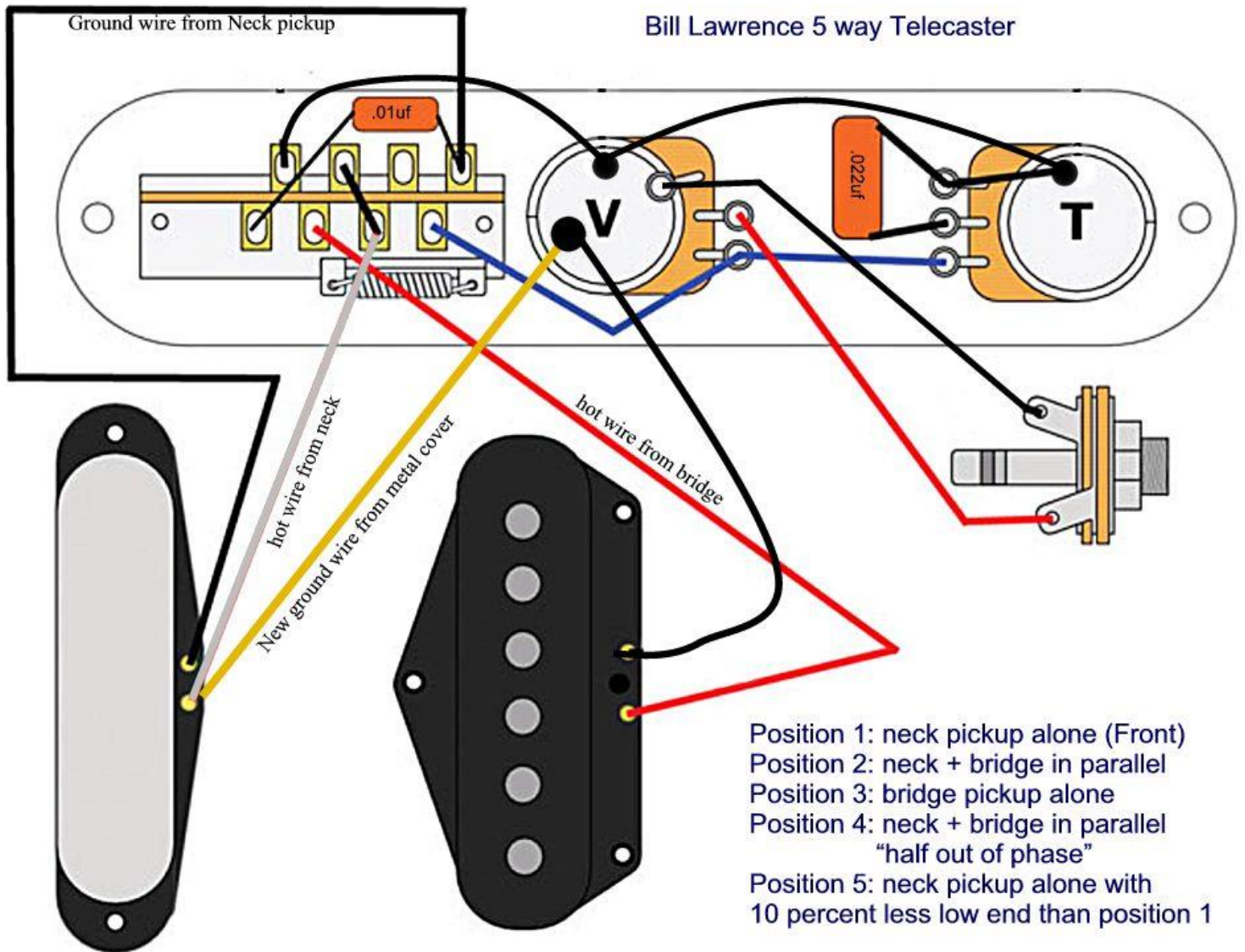

Image courtesy of singlecoil.com.

Normally on a Tele neck pickup, the black wire from the pickup goes to ground. However in this harness the black wire goes to the switch. If you have a Chrome (metal) cover on your neck pickup, the black wire does two things. It completes the circuit when it goes to ground and it also grounds the chrome cover. It does this by using a jumper underneath the pickup. The metal cover will need to be separated from the existing black wire and have it's own ground wire.

You do this by disconnecting the jumper and soldering a new wire to the chrome/metal cover lug and running the other end to the back of the volume pot. Please see the diagrams below.

If you are not sure how to proceed, please contact me by email, phone/Text from the CONTACT US page of this store.

BEFORE

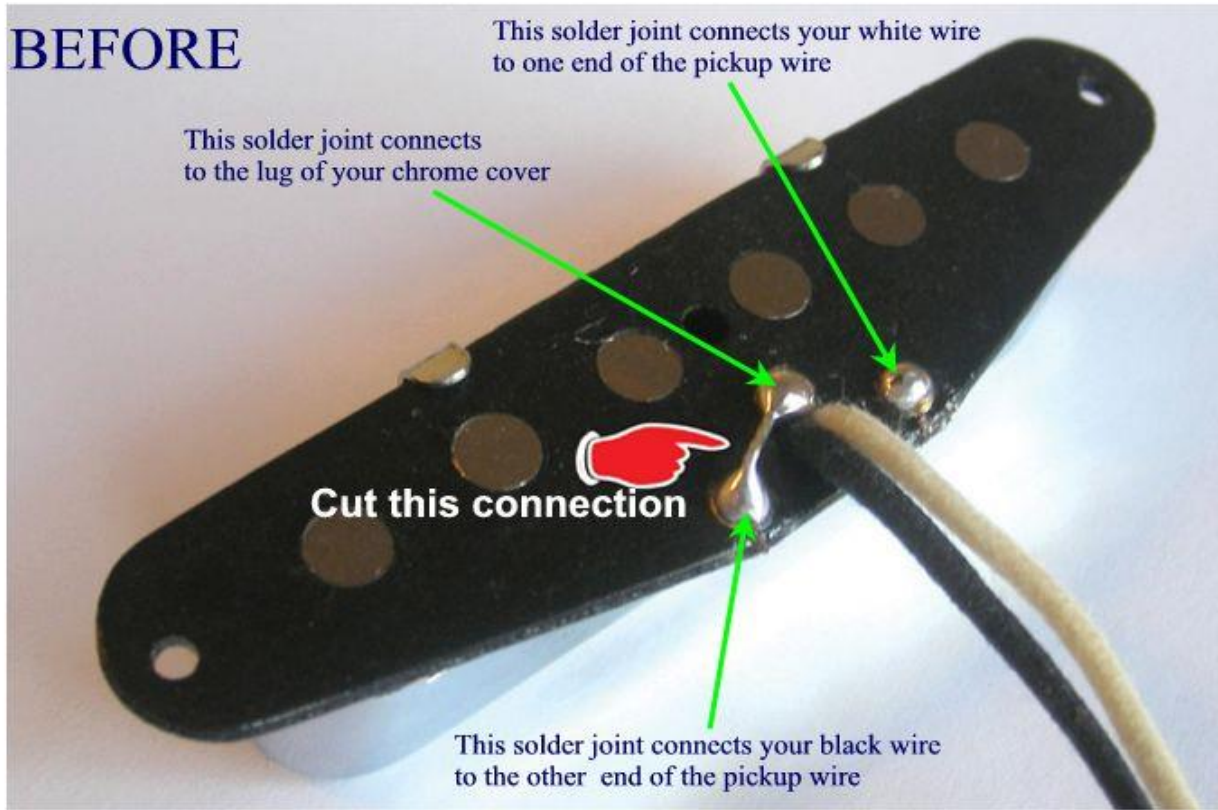

AFTER

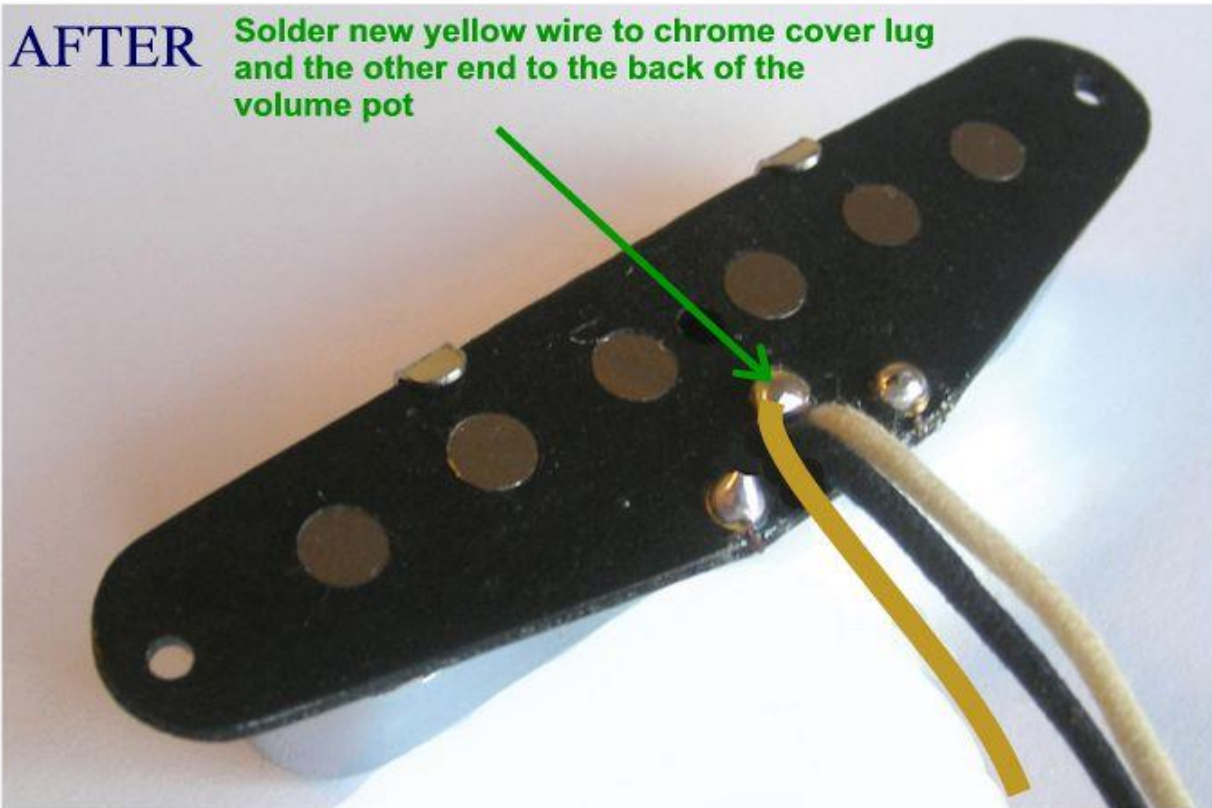

The wiring diagram below is for a **REVERSED** Bill Lawrence Harness

Bill Lawrence 5 way Telecaster Reverse Wiring Diagram

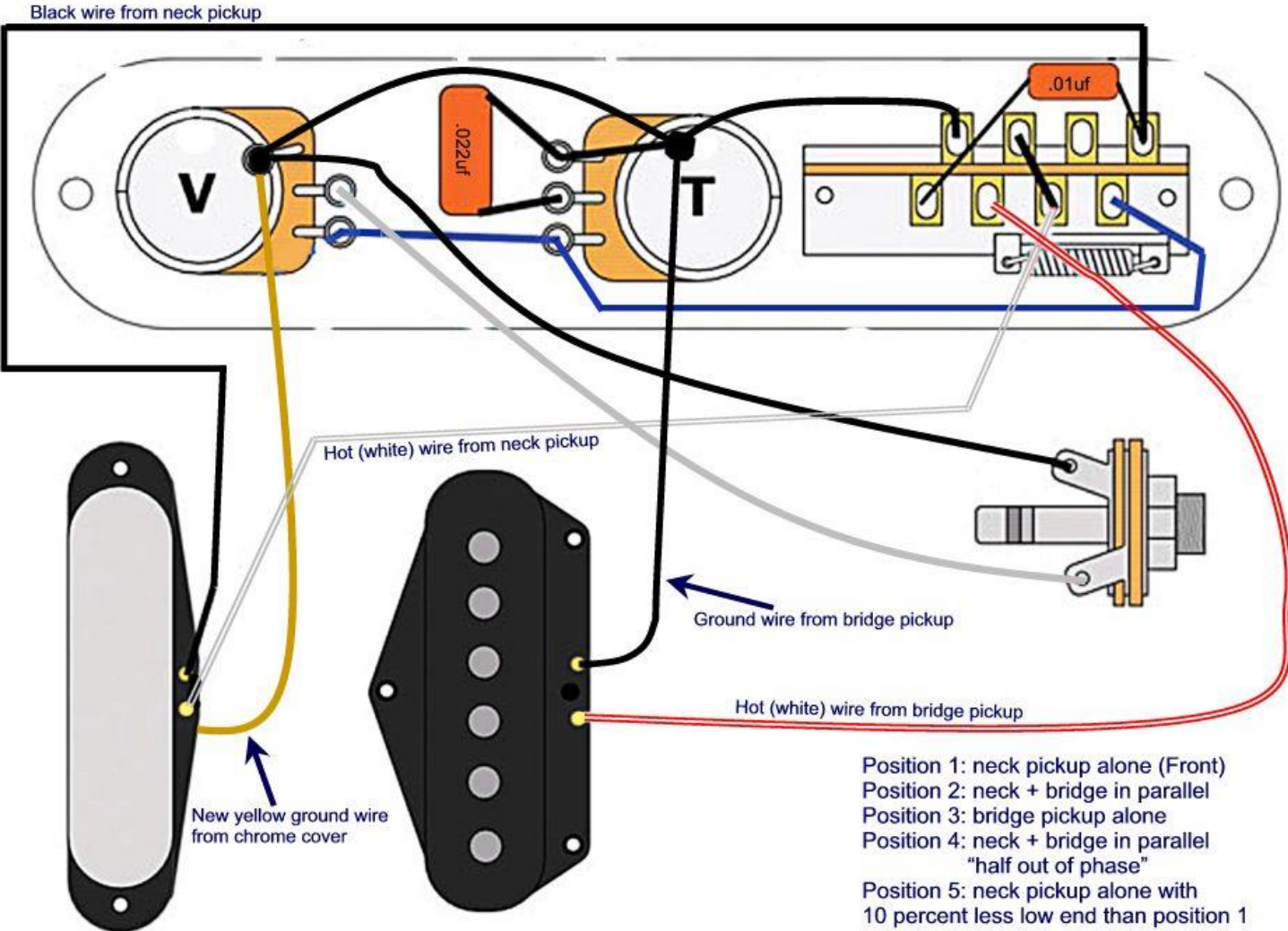

Image courtesy of singlecoil.com.

After building my Telecaster wiring harnesses, I hook them up to a test guitar in my workshop and play them. I check out all the switch positions, volume and tone controls. Once they check out 100%, I box them and ship them.